



ASSEMBLY INSTRUCTION speakON System

NL2FC / NL4FC / NL8FC
NL2MP / NL4MP / NL8MPR

Kabelstecker | Cable Connector

Kabelvorbereitung Cable Preparation

NL2FC

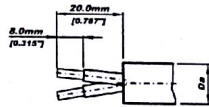

Da= 4.0 [0.157"] - 10.0 [0.394"]

NL4FC

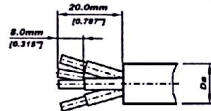

Da= 5.0 [0.197"] - 11.0 [0.433"]
... Spannange weiss; ... white chuck
Da= 9.5 [0.374"] - 15.0 [0.591"]
... Spannange schwarz

NL8FC

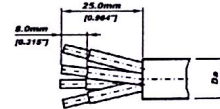

Da= 8.0 [0.315"] - 15.0 [0.591"]
... mit Reduzerring; ... with reducing sleeve
Da= 15.0 [0.591"] - 20.0 [0.787"]
... ohne Reduzerring; ... without reducing sleeve

Montage Assembling

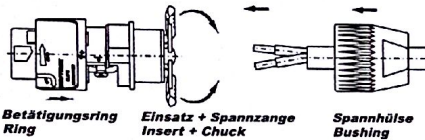

Betätigungsring Ring
Einsatz + Spannange Insert + Chuck
Spannhülse Bushing

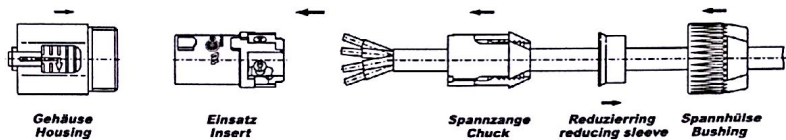

Gehäuse Housing
Einsatz Insert
Spannange Chuck
Reduzerring reducing sleeve (only to NL8FC)
Spannhülse Bushing

Verdrahtung Wiring

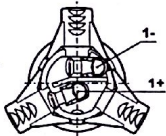

- Spannhülse auf Kabel schieben.
Put bushing onto the cable.
- Kabel lt. Anweisung vorbereiten.
Prepare cable as shown above.
- Drähte in die Klemmlöcher am Einsatz einführen und mit Schraube und Klemmblech mittels Schraubenzieher Pozidrive #1 befestigen.
Insert the wires into the terminals and fasten the clamping device with a screw driver Pozidrive #1.
- Betätigungsring in Richtung Spannange schieben.
Snap on locking ring into the chuck direction as shown above.
- Spannhülse mittels Gabelschlüssel SW 17mm fest anschrauben.
Fasten bushing by means of a fork wrench 11/16".

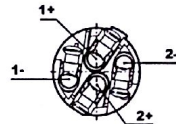

- Spannhülse u. Spannange auf Kabel schieben (Spannange kann auch nachträglich angebracht werden).
Put bushing and chuck onto the cable.
- Kabel lt. Anweisung vorbereiten.
Prepare cable as shown above.
- Drähte in die Klemmlöcher am Einsatz einführen und mit Schraube und Klemmblech mittels Schraubenzieher (Pozidrive) befestigen.
Insert the wires into the terminals and fasten the clamping device by means screw driver (Pozidrive).
- Einsatz und Spannange in das Gehäuse schieben (Führungsrippen und Führungsnut beachten!).
Push insert and chuck into housing (pay attention to the guiding keyway!).
- Spannhülse mittels Gabelschlüssel SW 19mm (NL8FC: SW 27mm) fest anschrauben.
Fasten bushing by means of a fork wrench 3/4".

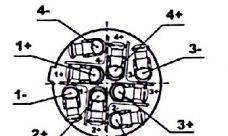

Bedienung Handling

Einsteck-Vorgang Engagement

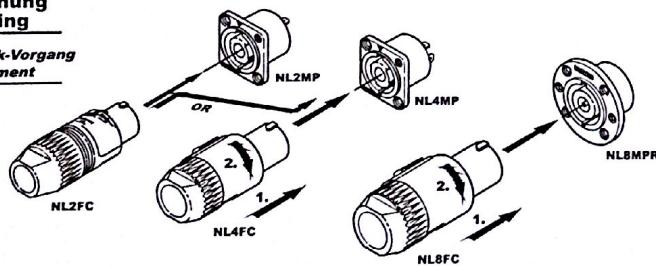

Aussteck-Vorgang Separation

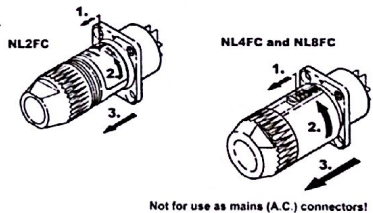

Not for use as mains (A.C.) connectors!

Gehäusestecker | Receptacle

Verdrahtung Wiring

NL2MP

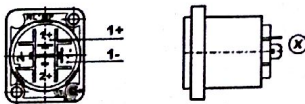

Frontplattenausschnitt (Rückseite) Panel Cutout (Rear Side)

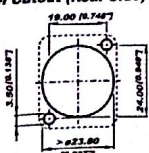

NL4MP

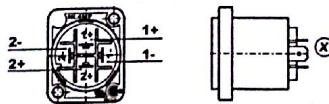

(X) für Flachsteckhülsen 4.8 mm x 0.5 mm
for flat quick-connect receptacles 0.187" x 0.020"

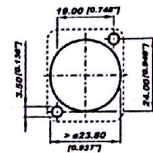

NL8MPR

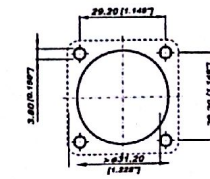
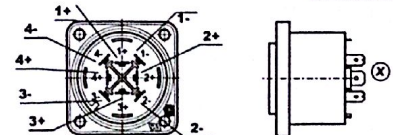

NEUTRIK AG LI T: +423 / 237 24 24 F: +423 / 232 53 93 NEUTRIK France FR T: +33 1 / 4131 6750 F: +33 1 / 4131 0511
NEUTRIK USA Inc. USA T: +1 704 / 972 3050 F: +1 704 / 438 9202 NEUTRIK Tokyo Ltd. JP T: +81 3 / 3663 4733 F: +81 3 / 3663 4796
NEUTRIK (UK) Ltd. UK T: +44 1983 / 811 441 F: +44 1983 / 811 439 NEUTRIK Hong Kong Ltd. HK T: +852 / 2687 6055 F: +852 / 2687 6052
NEUTRIK Vertriebs GmbH DE/NL/AT/DK T: +49 8131 / 280 890 F: +49 8131 / 280 830

Draft. Nr.: BDA 072 / 3102M0711 | Update: 14.10.2011 |

Data subject to change without prior notice. ©2011 NEUTRIK®. ALL RIGHTS RESERVED. NEUTRIK®, speakON® are registered trademarks.

www.neutrik.com

NEUTRIK