



2-Channel VHF Wireless Microphone System

Model Nos:

171.310	173.8MHz (Handheld) + 174.6MHz (Headset) - (UK)
171.311	175.0MHz (Handheld) + 174.2MHz (Headset) - (UK)
171.313	197.32MHz (Handheld) + 199.82MHz (Headset) - (EUROPE)
171.314	198.25MHz (Handheld) + 199.70MHz (Headset) - (EUROPE)



Operation Manual

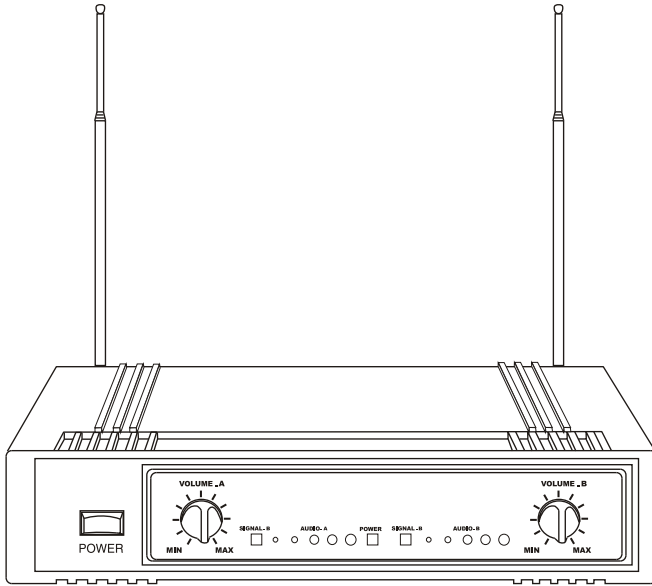

Receiver



Handheld Transmitter

Bodypack Transmitter

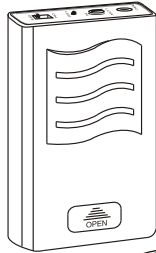

Headset Mic

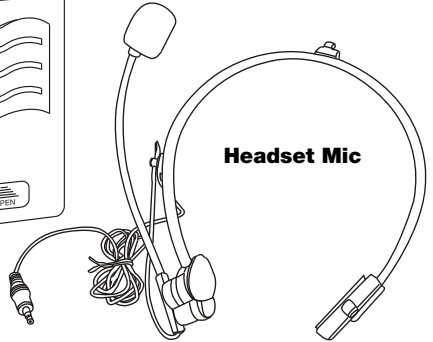

Antenna

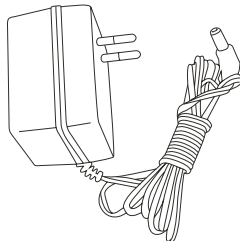

AC adaptor

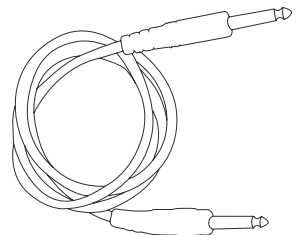

Audio cable



2-CHANNEL VHF WIRELESS MICROPHONE SYSTEM

Model Nos:

171.310	173.8MHz (Handheld) + 174.6MHz (Headset) - (UK)
171.311	175.0MHz (Handheld) + 174.2MHz (Headset) - (UK)
171.313	197.32MHz (Handheld) + 199.82MHz (Headset) - (EUROPE)
171.314	198.25MHz (Handheld) + 199.70MHz (Headset) - (EUROPE)

Thank you for buying this Skytronic VHF Wireless System. Please read through these operation instructions so you will know how to operate your model properly. After you read it, put it away in a safe place for future reference.

PRECAUTIONS

- Avoid exposure of the system to rain or moisture.
- No user-serviceable parts inside the system. Refer all servicing to a qualified technician only.
- Handle the wireless system carefully, dropping or other shocks may cause failure.
- Avoid using the system where it may be subjected to heat, such as direct sunlight, near radiators or other heat sources.
- Should any liquid be spilt on the system, stop using it immediately. It may be possible to dry the system, but you should have it checked by a qualified technician before using it again.
- Take care with the main power adapter and lead. If damaged in any way, do not use the system and refer to a qualified technician for repair.
- Only use the system with the supplied components. Do not attempt to use with any other main power supply adapter .
- If the is not going to be used for a while, remove the battery to prevent leakage. In the event of electrolyte leakage inside the battery compartment, carefully remove the leakage with a damp cloth. Take care not to get battery electrolyte in contact with your skin, however if it does, wash your hands under a running tap. If electrolyte comes into contact with your eyes, seek medical advice immediately.
- Only replace the battery with the same or an equivalent type.
- Please dispose of old batteries in an environmentally friendly manner in accordance with the relevant legislation.
- Do not use any solvents to clean any part of the wireless system.

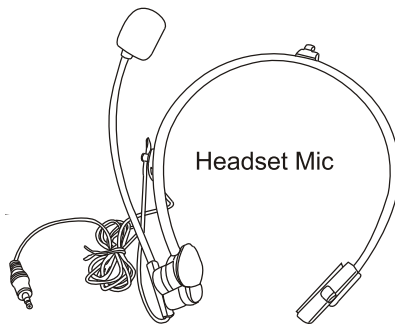
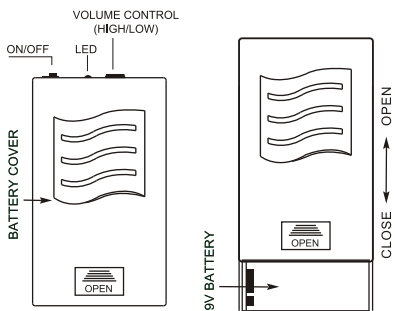

BODYPACK AND HEADSET

Operation

Push the battery cover on the front of the bodypack as per the diagram above and install a 9V battery, taking care to fit it with the correct polarity.

Check the battery by switching the microphone ON. The LED will come on for one second and then go off, this indicates correct operation. If the LED stays on or is dim, this indicates the battery is low and should be changed. If the LED does not come on at all, this indicates the battery is dead and should be changed.

You can adjust the volume control on the bodypack until you get the sufficient sound from your speaker.

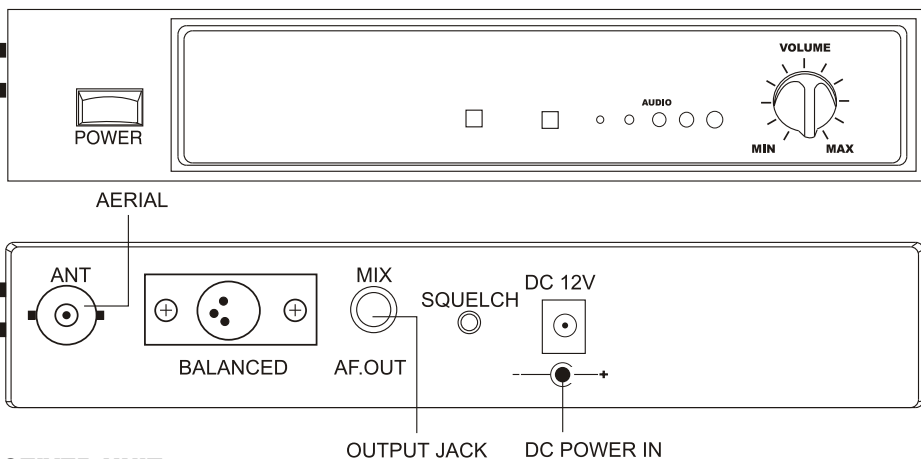

RECEIVER UNIT

Operation

Switch on the wireless microphone receiver unit by pressing the POWER switch and the POWER light will illuminate to show the receiver unit is working. Raise the aerial to the maximum height. The positioning of the aerial is not critical for performance, ideally it should be fully extended. Switch ON the microphone, checking that the red LED comes on for a second and then goes off. When the microphone is ON, the SIGNAL light will illuminate on the receiver unit.

The wireless microphone is now ready for use, adjust the volume and tone levels of your amplifier system as well as the receiver and the bodypack as required. When the wireless microphone is not being used turn OFF the microphone.

Note that switching the microphone on and off can cause interference that will be heard if the mic volume level of the amplifier system still set high.

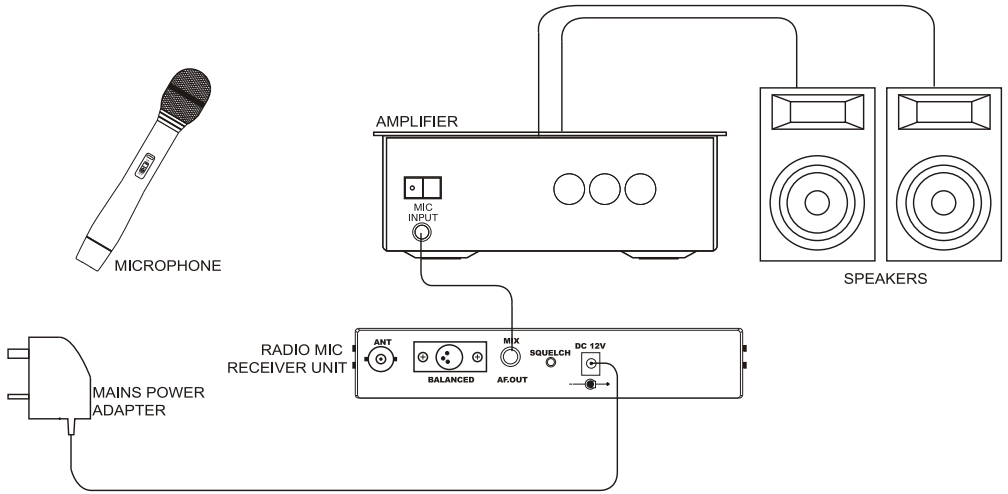

SYSTEM INSTALLATION

To connect the wireless microphone to your amplifier system refer to the installation diagram above.

Using the supplied screened jack-to-jack lead, connect from the AF OUT jack socket to the MICROPHONE INPUT socket on your amplifier. Plug the mains power adaptor into a suitable mains socket and plug the lead connector into the DC 12V input socket.

TROUBLE SHOOTING

The on air indicator does not light up	The wireless microphone is not turned on.	Turn on the wireless microphone
	The microphone receiver is not turned on.	Turn on the microphone receiver and the connected audio equipment
	The microphone receiver is not connected properly.	Turn on the microphone receiver and the connected audio equipment.
No sound	The battery in the wireless microphone is weak.	Replace the battery
	The microphone receiver is not turned on.	Turn on the microphone receiver and the connected audio equipment.
	The connected audio equipment is not turned on.	Turn on the audio equipment.
	The speakers/headphones. are not connected to the audio equipment.	Connect the speakers/headphones
The sound is distorted	The battery in the wireless microphone is weak.	Replace the battery.
	The AUDIO OUT on the receiver is not set correctly.	Adjust the volume cotrols.
A howling noise heard from the speakers.	The distance between the wireless microphone and speakers are too close.	Move the wireless microphone away from the speakers or change the direction of the microphone.
	The battery in the wireless microphone is weak	Replace the battery.

www.skytronic.com